

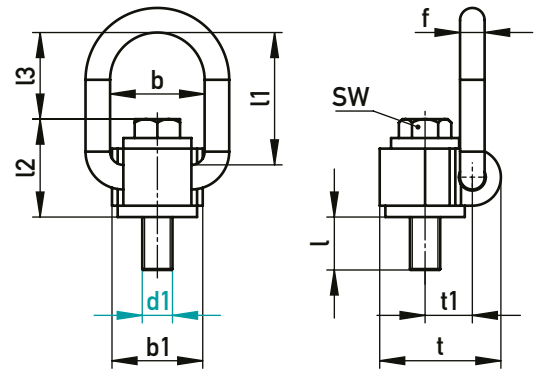





LASTBOCK, DREH- UND KLAPPBAR

LOAD RING, REVOLVABLE AND TILTABLE



Güteklasse 10/Quality grade 10

max. kg Sicherheitsfaktor 4:1 / max. kg safety factor 4:1

													Gewicht Weight (kg)	d1	€/1
max. kg*	max. kg*	max. kg*	l	l1	l2	l3	f	b	b1	t	t1	SW			
630	630	890	17	53	35	37	8,5	35	32	43	17	16	0,29	M10	•
1000	1000	1400	22	53	36	36	8,5	35	32	43	17	18	0,31	M12	•
1700	1700	2400	28	70	52	46	13	50	48	64	25	24	0,95	M16	•
2500	2500	3500	38	70	55	44	13	50	48	64	25	30	1,10	M20	•
4000	4000	5700	40	102	64	70	16	58	50	71	28	36	1,70	M24	•
6000	6000	8500	44	110	75	73	20	70	65	88	35	46	3,10	M30	•
8000	8000	11300	64	110	79	70	20	70	67	88	35	55	3,50	M36	•
10000	10000	14100	74	145	93	98	24	84	81	106	43	65	6,10	M42	•

*Weitere Informationen und aktuelle Nutzungshinweise entnehmen Sie bitte der Bedienungsanleitung.
You will find additional information and current terms of use inside the instruction manual.

✉ 40714/d1